

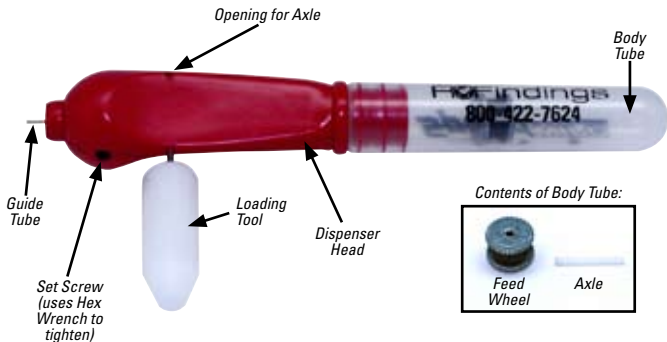

Loading Instructions for the Reloadable



Laser Welding Wire Dispenser



Hex Wrench included with each Speedwire
Other tools recommended: tweezers, magnifier

IMPORTANT: Read instructions before loading

IMPORTANT: Do not remove Loading Tool before instructions indicate to do so. Early removal will result in interior spring and plunger loss.

Before loading Dispenser for first time, remove parts from Body Tube

Step 1 Insert white plastic Axle into side of Dispenser Head so it is secure but not protruding into the Wheel Cavity.

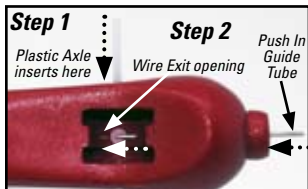

Step 2 Make sure that Guide Tube is pushed into Wheel Cavity to within 1mm of the Wire Exit opening.

Step 3 Insert straight end of your coiled laser wire into rear of Dispenser Head until it emerges into Wheel Cavity and enters into Guide Tube. **Push wire into Guide Tube at least 10mm.**

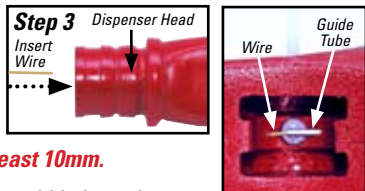

NOTE: Clipping wire end on a bias may aid in insertion. Tweezers may be used to assist in pushing the wire into Guide Tube.

Step 4 Place clear Body Tube over wire coil and snap onto Dispenser Head.



Step 5 With one hand, gently pull down on Loading Tool to release pressure on Guide Tube. While pulling down on Loading Tool, pull Guide Tube forward until it is no longer visible in Wheel Cavity. **DO NOT REMOVE LOADING TOOL YET.**

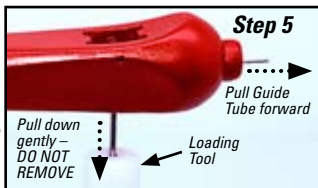

Step 6 Use hex wrench included in package to tighten set screw.

NOTE: Tighten only enough to hold Guide Tube in place.

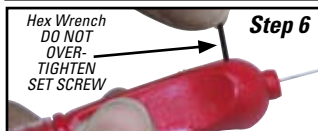

Step 7 Examine Feed Wheel to locate side with beveled hole (see inset).

Place Feed Wheel in Wheel Cavity with beveled hole facing Axle. Hold Feed Wheel down in Wheel Cavity with your thumb.

Step 8 While still holding Feed Wheel in place, pull on Loading Tool until it detaches from Dispenser.

Step 9 Use the hole in the tapered end of Loading Tool to push Axle through hole in Feed Wheel.

Step 10 Using flat surface of tapered end of Loading Tool push Axle completely into hole on opposite side of Wheel Cavity.

Step 11 Rotate Feed Wheel toward rear of dispenser until wire emerges from Guide Tube.

Wrap the laminated label provided with wire coil at top of Body Tube to help keep track of the metal and gauge loaded in each dispenser.

Your Speedwire Dispenser is now ready for first use.

Save these instructions, the Loading Tool and hex wrench for re-loading.

Reloading instructions appear on next page

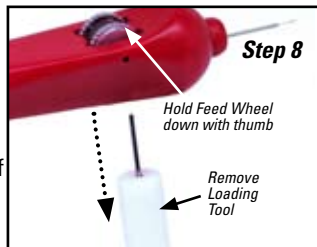
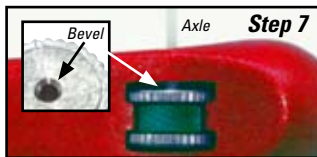

Loading a Replacement Wire Coil

Step A Remove the clear Body Tube from Dispenser Head.

Step B Loosen set screw slightly on underside of Dispenser Head with the hex wrench that was provided to free Guide Tube.

Step C Holding Feed Wheel in place, use Loading Tool to push white plastic Axle out far enough to free the Feed Wheel. Leave Axle protruding from side of Dispenser Head as seen in Step 2 on inside instructions.

Step D While holding Feed Wheel firmly in place, insert the Loading Tool pin through small hole on underside of Dispenser Head, pushing it into the plunger. Pull gently on Loading Tool to make sure it is firmly in place.

Step E Remove Feed Wheel and set aside. You are now ready to begin loading a new annealed wire coil.

Proceed to ***Step 2*** in the *Loading for the First Time* instructions.

Replacement parts and annealed wire coils may be ordered from



The Findings Specialists

800-422-7624

www.rfindings.com